

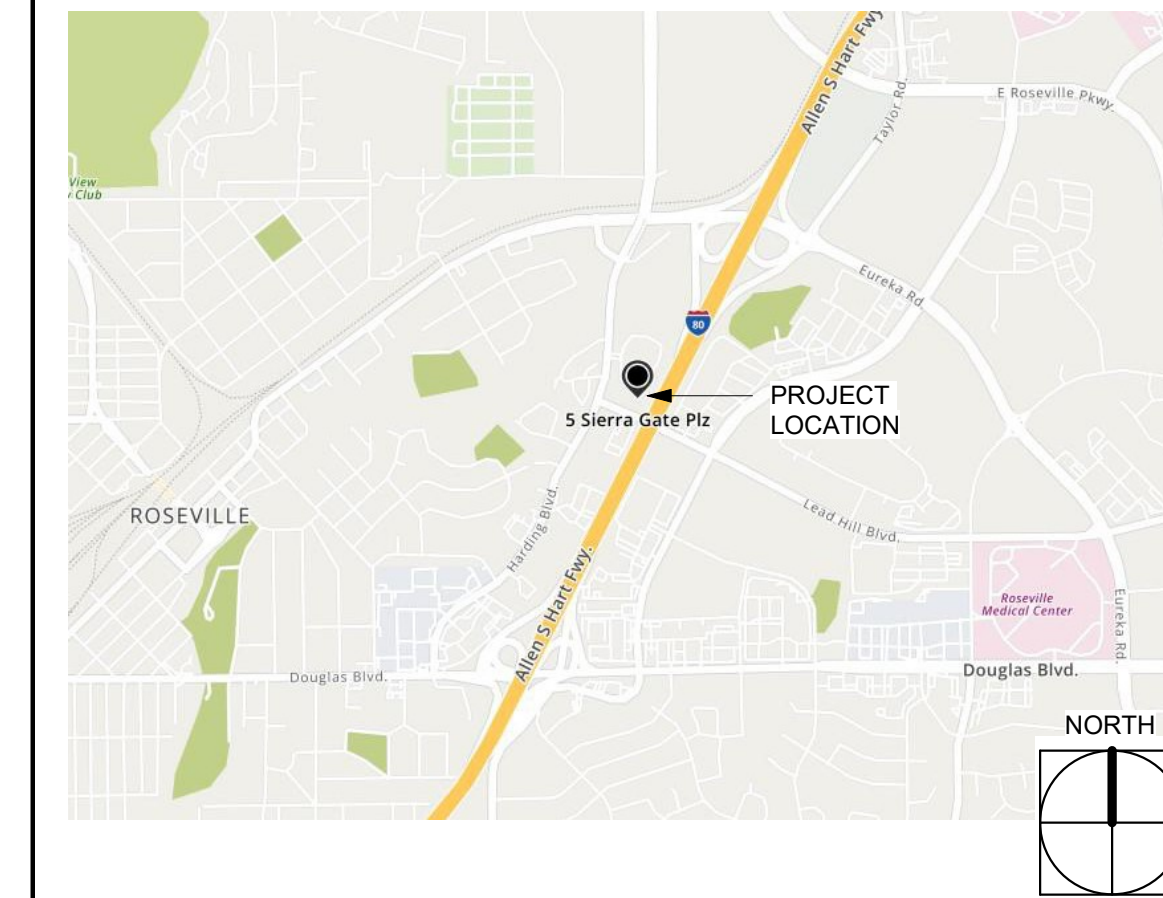

F5 OVERALL SITE PLAN
SCALE: 1" = 20'-0" EXISTING (SHOWN FOR REFERENCE ONLY)

VICINITY MAP



SITE DATA

ASSESSOR'S PARCEL:	015-240-023-000
JOB SITE ADDRESS:	5 SIERRA GATE PLAZA, ROSEVILLE, CA 95678
USE ZONE:	BP - BUSINESS PROFESSIONAL/ OFFICE
PARCEL AREA:	119,812 SQ. FT. (2.75 ACRES)
FLOOD ZONE:	NO
EXISTING BUILDING	
OCC. CLASSIFICATION AND USE:	B (BUSINESS), S-1 (STORAGE)
BUILDING CONSTRUCTION TYPE:	II-B
NUMBER OF STORIES:	3 (ABOVE GROUND LEVEL)
HEIGHT OF BUILDING:	+50'-0" (ABOVE GROUND LEVEL)
BUILDING TOTAL GROSS AREA:	37,000 SQ. FT.
1ST FLOOR:	13,000 SQ. FT.
2ND FLOOR:	12,000 SQ. FT.
3RD FLOOR:	12,000 SQ. FT.
YEAR BUILDING WAS CONSTRUCTED:	UNKNOWN
EXISTING TENANT IMPROVEMENT	
OCC. CLASSIFICATION AND USE:	B (BUSINESS), S-1 (STORAGE), E (CLASSROOM) TOTALING 2,341 SQ. FT.

PARKING COUNT

VEHICULAR PARKING COUNT IS BASED ON ROSEVILLE MUNICIPAL CODE, TITLE 17, CHAPTER 19.26.030. MINIMUM PARKING REQUIREMENTS ARE:

OFFICE (34,859 SQ. FT.):	1 SPACE PER 250 SQ. FT. NET
EDUCATION (2,341 SQ. FT.; 4 CLASSRMS.):	2 PER CLASSROOM
REQUIRED:	
STANDARD:	141 SPACES
ACCESSIBLE:	5 SPACES
VAN ACCESSIBLE:	1 SPACES
TOTAL:	147 SPACES
PROVIDED:	
STANDARD:	189 SPACES
ACCESSIBLE:	5 SPACES
VAN ACCESSIBLE:	1 SPACES
TOTAL:	195 SPACES

KEYNOTES

- EXISTING PUBLIC RIGHT-OF-WAY CONCRETE WALK TO REMAIN, TYP.
- EXISTING CONCRETE WALK WITH CURBS TO REMAIN, TYP. THROUGHOUT THE SITE.
- EXISTING LANDSCAPE PLANTER TO REMAIN, TYP. THROUGHOUT THE SITE.
- EXISTING ASPHALT PAVEMENT TO REMAIN, TYP. THROUGHOUT THE PARKING LOT.
- EXISTING PARKING STALL STRIPING, 4" WIDE WHITE TRAFFIC PAINT TO REMAIN, TYP. AT NON-ACCESSIBLE PARKING.
- EXISTING ON-SITE MASONRY TRASH ENCLOSURE WITH METAL GATES TO REMAIN.
- POLE MOUNTED SITE ENTRANCE SIGN, TYP. AT EACH VEHICULAR ENTRANCE. SEE DETAIL AS INDICATED.
- POLE MOUNTED ACCESSIBLE PATH OF TRAVEL/ ROUTE SIGN WITH ARROW INDICATING DIRECTION TO BUILDING MAIN ENTRY.
- EXISTING LIMITED ACCESS DRIVEWAY TO REMAIN.
- EXISTING FENCING TO REMAIN, TYP.

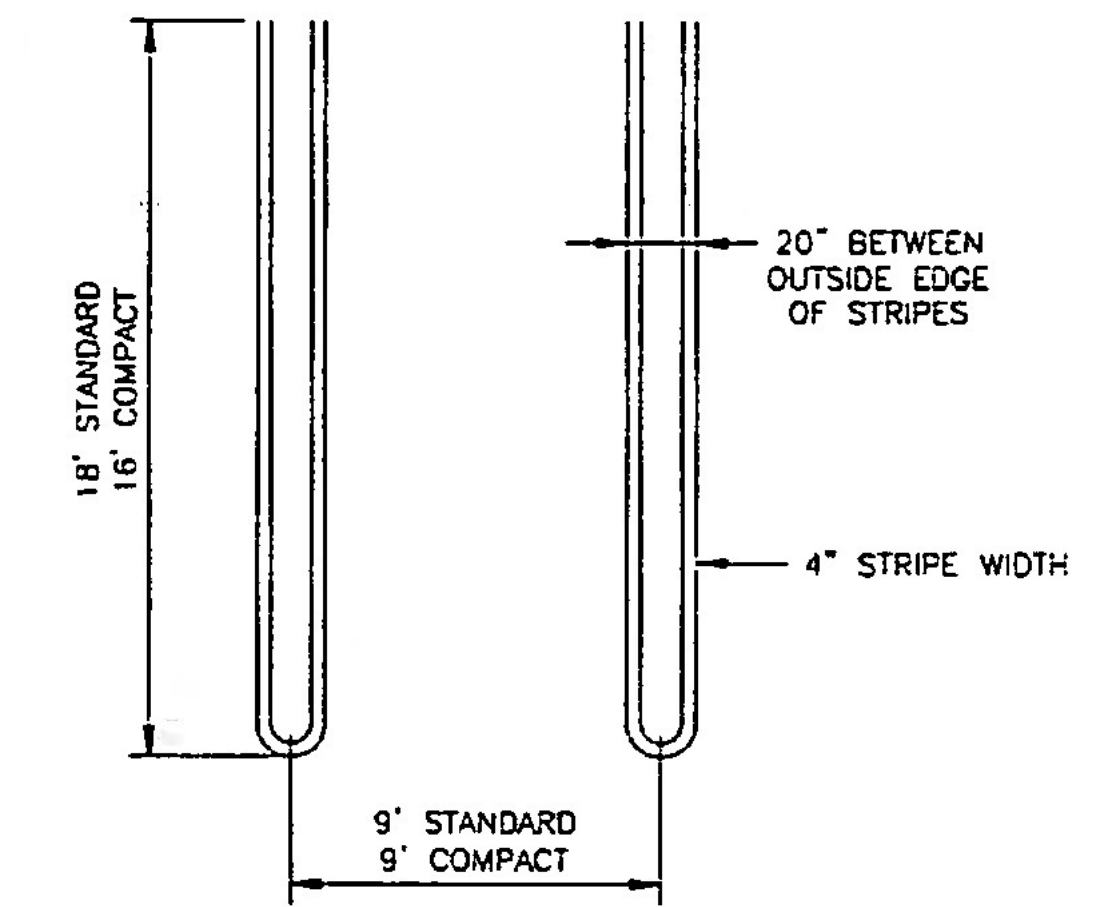

B5 PARKING DOUBLE-STRIPE DETAIL
SCALE: 6" = 1'-0"

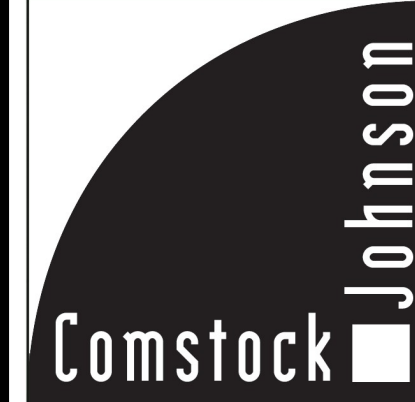

ARCHITECTS INC.
10820 Gold Center Drive, #250
Rancho Cordova, CA 95670
Phone: (916) 362-6303

- Daniel P. Erikson
Principal Architect
- Kevin L. Wilcox
Principal Architect
- Jeffrey J. Reilly
Principal Architect
- Rachel M. Luhrsen
Principal
Sr. Project Manager



COMSTOCK JOHNSON ARCHITECTS, INC. (CJA) hereby expressly reserves its common law copyrights and other property rights in these drawings and specifications and as instruments of Service are and shall remain the property of CJA whether the Project for which they are made is executed or not. These drawings and specifications are not to be reproduced, changed or copied in any form or manner whatsoever, nor assigned to any third party without first obtaining the express permission and consent of CJA by an agreement in writing and with appropriate Reuse Fee compensation being paid to CJA.

JOB TITLE:

TENANT IMPROVEMENTS FOR:
JOHN ADAMS ACADEMY T.I., SUITES 100 & 150
5 SIERRA GATE PLAZA, ROSEVILLE, CA 95678

REVISIONS:

DATE	DESCRIPTION

DATE 31 JAN 2025
DRAWN KLW/ YT
JOB NO. 2025014.00

SHEET
CUP A1.0
OVERALL SITE PLAN



A. EXTERIOR ELEVATION



B. EXTERIOR ELEVATION



C. EXTERIOR ELEVATION



D. EXTERIOR ELEVATION



E. EXTERIOR ELEVATION



F. EXTERIOR ELEVATION



G. EXTERIOR ELEVATION



ARCHITECTS INC.
10820 Gold Center Drive, #250
Rancho Cordova, CA 95670
Phone: (916) 362-6303

Daniel P. Erikson
Principal Architect
Kevin L. Wilcox
Principal Architect
Jeffrey J. Reilly
Principal Architect
Rachel M. Luhrs
Principal
Sr. Project Manager



COMSTOCK JOHNSON ARCHITECTS, INC. (CJA) hereby expressly reserves its common law copyrights and other property rights in these drawings and specifications and as instruments of Service are and shall remain the property of CJA whether the Project for which they are made is executed or not. These drawings and specifications are not to be used by the Client on other Projects or extensions to this Project nor are they to be reproduced, changed or copied in any form or manner whatsoever, nor assigned to any third party without first obtaining the express permission and consent of CJA by an agreement in writing and with appropriate Reuse Fee compensation being paid to CJA.

JOB TITLE:

TENANT IMPROVEMENTS FOR:
**JOHN ADAMS ACADEMY T.I.,
SUITES 100 & 150**
5 SIERRA GATE PLAZA,
ROSEVILLE, CA 95678

REVISIONS:

DATE	DESCRIPTION

DATE 31 JAN 2025
DRAWN KLW/ YT
JOB NO. 2025014.00

SHEET
CUP A3.0
EXTERIOR ELEVATIONS